

Installation Instructions

Tools Required: Scissors or utility knife
 Staple Gun or Staple hammer
 Caulk gun and RainEscape® Caulk

PREP - Place a mid-span nailer on the underside of the joists to keep them straight.

Step 1. Installing the RainEscape® Downspout -

Cut downspout along the 16" o.c. side or the 12" o.c. side. Check caulking instructions prior to installations. (See #3) Downspout should extend 1" into the gutter. Cut or extend as needed.

Step 2. Installing the RainEscape® Trough -

Check caulking instructions prior to installation. (See #3) If starting at a structure, place the first 3" of the trough up under the siding. With the smooth side up, place the wider 4" flange to the outside of the deck, and the 1 1/2" flange should line up with the top of the second joist. Place your first staple at the beginning on the 1 1/2" flange side. Roll the trough out to the downspout, line the score mark up with the inside of the joist, pull tight and place your second staple. Cut the trough to within 1" of the backside of the downspout. **Back roll the last few inches to remove any memory.** Push the trough down into the downspout. Line the trough up on top of the opposite joist, pull tight and place a third staple. Across from your first staple pull tight so that the trough is wrinkle free and place your fourth staple. Staple both sides of trough every 6" to 8".

Note: For every 12' and 16' span the score marks will line up with the inside of the joists.

Repeat Step 1 and 2 for remaining joists.

Step 3. Caulking RainEscape® Trough & Downspout -

Caulk the perimeter of the deck. (Ledgers, outside joists, rim joists, etc.) Wherever the RainEscape® downspout or troughs overlap place a bead of caulk between the two.

Do's

- Make sure your joists are straight and square.
- Make sure the trough is wrinkle free and has proper fall to the downspout.
- Gutters should have outlets every 12' to 14'.
- When installing electrical fixtures, electronic equipment, wiring, fans, etc. first check with your local building department regarding permits and codes.
- Use approved screws ONLY to install decking

Don'ts

- Do not staple RainEscape® anywhere other than over or into floor joists, ledgers, rim joists, headers, etc.
- Don't stand anywhere other than directly on top of floor joists, ledgers, rim joists, or headers as the RainEscape® system will not support you.

CAUTION: May be slippery when wet.

RainEscape®

THE DECK DRAINAGE SYSTEM

PATENT# 6694686



Install Downspouts



Mid-span nailer keeps joists straight, remove when project is complete.



Cut to 12" or 16"



Caulk rim joist



Set downspout then staple

Install Troughs

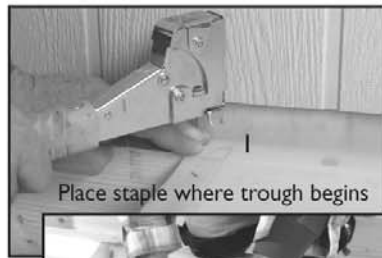

Place staple where trough begins

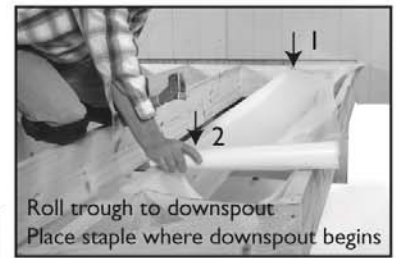

Roll trough to downspout
Place staple where downspout begins



Roll back to remove memory

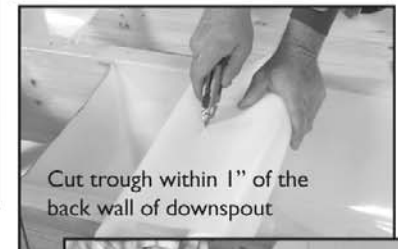

Cut trough within 1" of the back wall of downspout

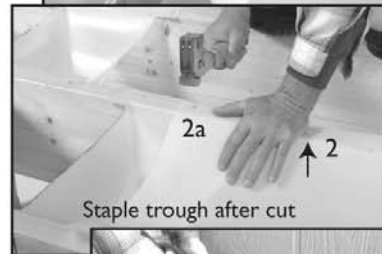

Staple trough after cut



Pull tight and staple over downspout

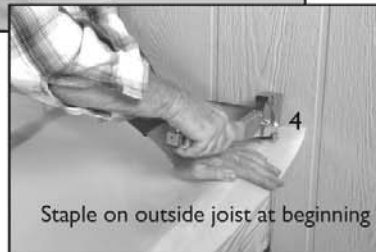

Staple on outside joist at beginning

Caulk all perimeter areas

Caulk wherever downspout or troughs overlap



Modifications, Obstructions and Cantilevered Installation Instructions

Modifying Downspout for bays down to 6" -

- 1) Cut the appropriate side of the downspout.
- 2) Cut the corners of the downspout from the desired width to the outside flange at a 45 degree angle. Cut the backside of the downspout straight up from the bottom of the 45 degree angle cut to the outside of the downspout. NOTE: The backside of the downspout will be the desired width.
- 3) Check Caulking instructions (Step 3) and install downspout.
- 4) Place a piece of RainEscape® tape over the cut corners of the downspout overlapping both sides. Where the top of the downspout and RainEscape® tape meet cut the tape straight up and fold over onto the downspout flange. Cut a small piece of tape overlapping the previously installed tape and covering the corner.

Obstructions -

Only the trough material can be cut to accommodate obstructions. Downspouts must be relocated. All obstructions must be alongside a joist or at the beginning of a trough.

- 1) Mark out the location of the obstruction and cut from corner to corner.
- 2) Install or re-install obstruction
- 3) Wrap RainEscape® tape around the obstruction cutting the tape at a 45 degree angle in the corners. Place a small piece of tape over the corners overlapping the previously installed tape.

Spans of 19' and 45 degree angles -

- 1) Draw a line from corner to corner extending down 1" in the center. Cut the downspout following the line.
- 2) Check caulking instructions (Step 3) and install downspouts either in a straight line or along the angle.
- 3) Install troughs by repeating Step 2. On the front side make sure the 3' or less trough overlaps the previously installed trough.

Spans over 19' -

- 1) Place double blocks where the downspouts or troughs or both are to begin.
- 2) Check caulking instructions (Step 3) and install downspouts or troughs over the double blocks.
- 3) Place RainEscape® tape overlapping the downspouts, or trough and downspout, or troughs.

CAUTION: May be slippery when wet.

Modifying RainEscape® Downspouts



Dealing with Obstructions

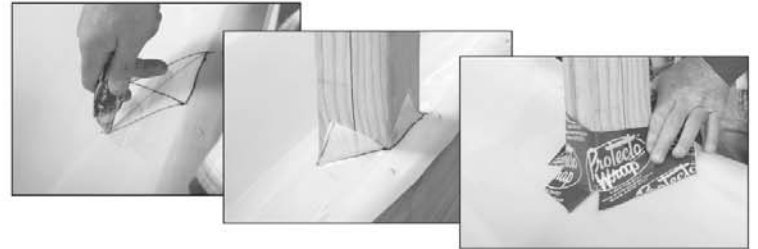

Spans of 19' and 45 degree angles

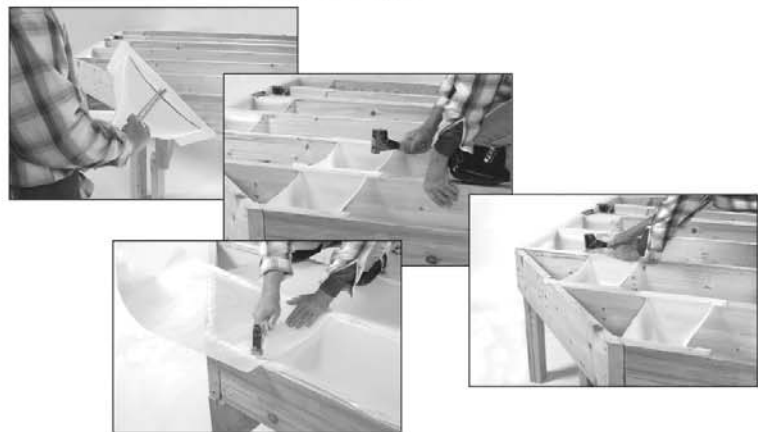

Spans over 19'



RainEscape®

THE DECK DRAINAGE SYSTEM

PATENT# 6694686

REII v.4.06